

NATIONAL BARN COMPANY[®]



EQUIPMENT SHEDS • STABLES
HAY SHEDS • AIRPLANE HANGARS
STORAGE BUILDINGS • HOMES
ENCLOSED RIDING ARENAS • BARNS
HURRICANE RATED BUILDINGS



EASTERN DIVISION

As president of National Barn, I am grateful that you have given us the opportunity to earn your business. In the ten short years since we opened the territory, we have gained over 8,000 satisfied customers and expanded our work force to over 70 full-time professionals.

By providing licensed and insured professional services, we continue to witness phenomenal acceptance and growth (in the nine state area of the Southeast).

Please take a few moments to review our materials. We want you to make an informed decision about your building, and we are confident that you will be completely satisfied with National Barn Company.

Sincerely,

Sam Lamberth
President, National Barn



*We build every
barn as if it were
our own...*

Our Mission

National Barn will build quality, economical, warranted post frame buildings; installed in a timely manner, by full-time professional builders.

Our Primary Goal

We want to exceed the expectations of every customer, every day, and to build relationships and structures to last a *lifetime*.

Quality construction, consisting of...



5" x 5" or 6" x 6" CCA treated posts set 10' on centers

- (12' centers are used on some buildings).
- Standard post depth is 36" - Based on level ground. Deeper in IN.
- Hurricane and higher wind zones may require closer post spacing.



2" x 6" MCQ Treated Bottom Plate. (Bottom Plate can be used as a form for pouring a concrete slab).



Double 2" x 6" Header Plates Minimum. (2" x 8", 2" x 10" or 2" x 12" used where spans or codes require.)



2" x 4" Wall Girts spaced 24" apart.



2" x 4" Wind Bracing. (2" x 6" on Hurricane Blds.)



Factory Engineered Trusses set on 5' centers. Some buildings the trusses are set on 6', 4' or 2' centers. Top chord and bottom chord are typically 2" x 6".

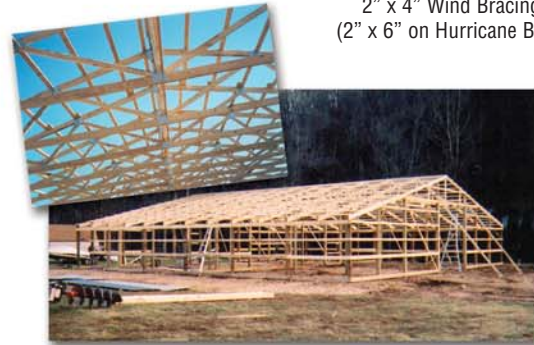
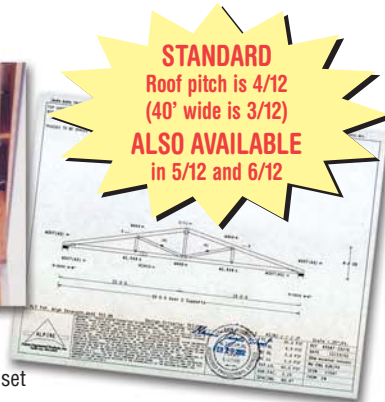

2" x 4" Roof Purlins spaced 24" apart, laid continuous.



V-Braces are used on open walls, sheds and porches—made from our posts for added strength and aesthetic value.

29 or 26 gauge metal - Galvanized or Painted. Painted metal has a manufacturer's lifetime limited warranty. Metal attached with color matching screws.

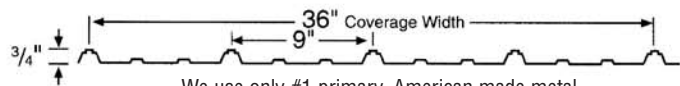

We use only #1 primary, American made metal.

NOTE:

All lumber is #2 Grade Southern Yellow Pine. Lumber that has ground contact is fully treated. Posts have a .60 CCA treatment. Lumber can be upgraded for an additional cost, or modified to meet local building restrictions.

Select the options that fit your needs...

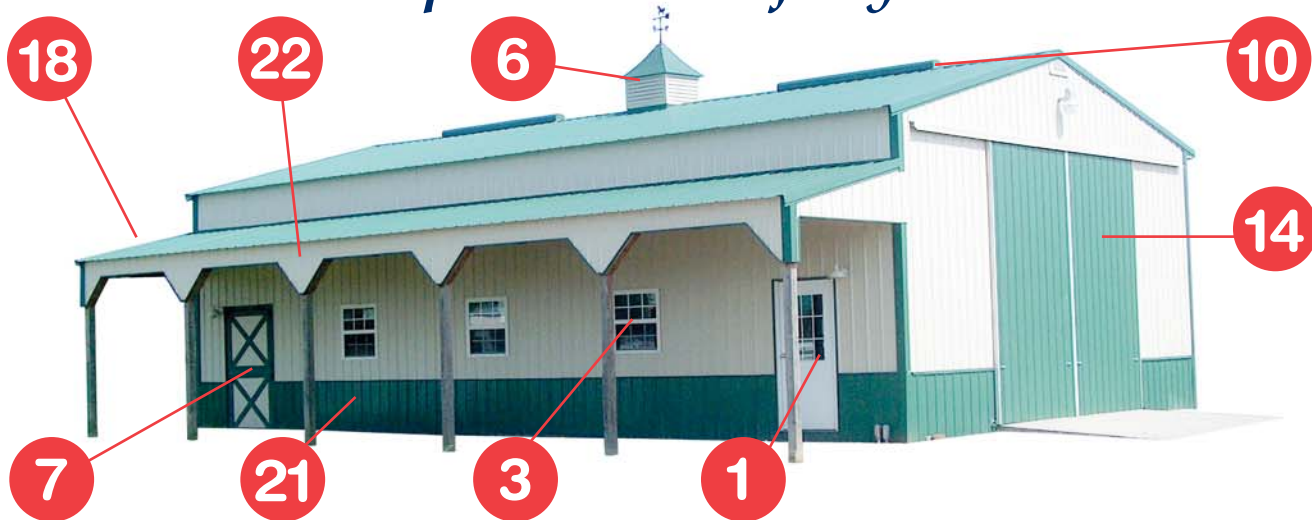

1. WALK DOOR



- Pre-hung door with keyed lockset
- Standard Size - 3' x 6' 8"
- Economy or Heavy Duty
- Available with 22" x 36" glass (with divided lite)
- Raised panel or cross buck as an option

2. BOTTOM DOOR RAIL

Wind resistant bottom door rails provide stability when your sliding door is open. Available two ways (1) as part of the premium slider package or (2) it can be purchased separately.



3. WINDOWS

- Single-Hung Vinyl Window with insulated glass
- Standard sizes: 2'x3', 3'x3', or 3'x4'
- Standard color is white
- Custom windows are available



4. POST PROTECTOR

- Moisture and Insect protection
- Uplift protection
- Lifetime warranty
- Continuous venting
- Environmentally safe
- Add value to your building



5. SOFFIT & FASCIA

- Metal Soffit Panel w/Ventilation
- Metal Fascia Trim
- Standard size is 12" (also available in 18" or 24")
- Many colors to choose from

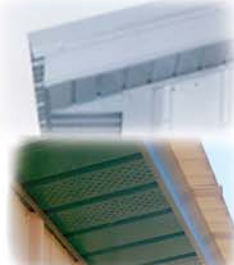

6. CUPOLA

- 3' x 3'
- 29 gauge steel
- 29" steel weathervane
- Many colors available
- Also available in 2' x 2' or 4' x 4'
- Weathervanes: Rooster, Eagle, Horse, Cow, Pig, Deer (may also be purchased separately)



7. DUTCH DOOR

- 16 gauge steel frame
- 3/4" plywood core w/29 gauge metal
- Many colors available
- Horse Friendly; Top section can swing separately and latch against wall



8. GRILL DUTCH WINDOWS

Grill Dutch Windows provide decorative appeal as well as excellent stall ventilation.



9. HORSE STALLS

- 10' or 12' front w/grill
- 4' sliding door w/grill
- Powder coated finish (many colors)



Optional features include: Grilled dividers, swing out feeders, and drop down panels.

10. RIDGE VENT

- 10" low profile
- Ideal for attic ventilation
- Bird proof
- Many colors



11. GABLE VENT

- Different sizes available
- Custom colors to match



12. SLAB CONSTRUCTION

Construction available on a pre-existing slab.



13. SINGLE SLIDER



Typical width; 10' or 12'
(cannot exceed 12' wide)

14. SPLIT SLIDER



Typical width; 12', 14', 15', 20' (width of door is limited by width of building)

15. SLIDER W/CROSSBUCKS



Sliding doors are available with crossbuck design. 1" x 4" crossbucks shown with metal trim.

NOTE:

- Sliding door clearance is 1' lower than wall height
- Steel vertical rails are standard
- Doors latch from the inside
- Color matches the walls, unless requested otherwise
- Split slider has interlocking steel meeting rail and center latch
- Bottom door track is not standard, but available at additional cost

16. OPEN ENDED SHED

Open on sides and end.
5"x5" or 6"x6" v-bracing provided on all posts creates decorative appeal as well as structural integrity.



17. FRAME-OUT FOR OVERHEAD DOOR



Typical width; 8', 9', 10', 12' or 16'. Openings are framed and trimmed for an overhead door. Cropped corners are optional.

NOTE:

- Frameout height is limited by the clearance needed for the housing or track - typical clearance is 2', therefore the door height is 2' lower than the wall height
- If you are pouring a concrete slab you must allow for the thickness of the concrete under the door
- Check with your door supplier to verify the rough opening size and required clearance if National Barn is not installing your door.

18. HURRICANE SERIES

If you live near the coast, your basic framing should look like this! National Barn provides engineered "hurricane" buildings to meet wind load requirements in coastal regions.



19. SHED

Open on side. Can be closed on all sides for additional room.



20. SPECIAL!

Our advertised special: This 30'x50'x10' painted building is the lowest cost per square foot available on the market today. (Shown here with a standard walk door.)



NOTE:

- Metal ceilings are not included with these options unless noted otherwise on the contract
- Drop porches/sheds are also available (see building on top of page 3 for example)

ADDITIONAL OPTIONS

- 21. WAINSCOTING** - Bottom 3' or 4' of wall metal different color
- 22. COVERED V-BRACES** - Metal trim over wooden V-Braces
- 23. CONTINUOUS VENTED RIDGE** - Vented foam strips under ridge cap
- 24. RAT GUARD** - Metal trim to close the ribs at the bottom of the wall
- 25. BALE DOOR** - 29 gauge steel, ply-wood core. Excellent durability.
- 26. TACK ROOMS/FEED ROOMS** - Interior room, typical size 10' x 10', 12' x 12'. Available with or without metal ceiling

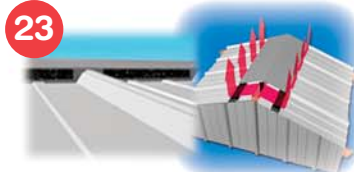

National Barn uses Ply-Foil Insulation

PLY-FOIL PROVIDES YOU WITH UP-TO-DATE INFORMATION

Over the years, Ply-Foil has collected and continues to collect test data on applications using its insulation products. On this page, we discuss applications for post frame and metal buildings including benefits and installation procedures.

Ply-Foil Reflective Insulation has been tested by independent government approved laboratories. These tests provide the contractor with accurate and useful information on system thermal performance.

Reflective insulation is effective when installed with at least 3/4" of airspace between the insulation and surrounding surfaces. The thermal (R-value) of the insulation system will vary depending on the size of the airspace and the direction of heat flow. Due to heat losses caused by differences in convection, conduction, and radiation, several different R-values are achieved with the same product.

Ply-Foil products have also been extensively tested for system thermal properties, flame spread, vapor transmission, mold and mildew resistance, emittance, smoke density, and physical properties. Test data is available. Contact factory.

PLY-FOIL BLOCKS RADIANT HEAT TRANSFER

According to an analysis performed at Penn. State University, approximately 75% of total heat transfer in structures occurs through radiation. The foil in Ply-Foil reflects 97% of radiant energy striking it. (See Illustration)

- RADIATION
- CONDUCTION
- CONVECTION

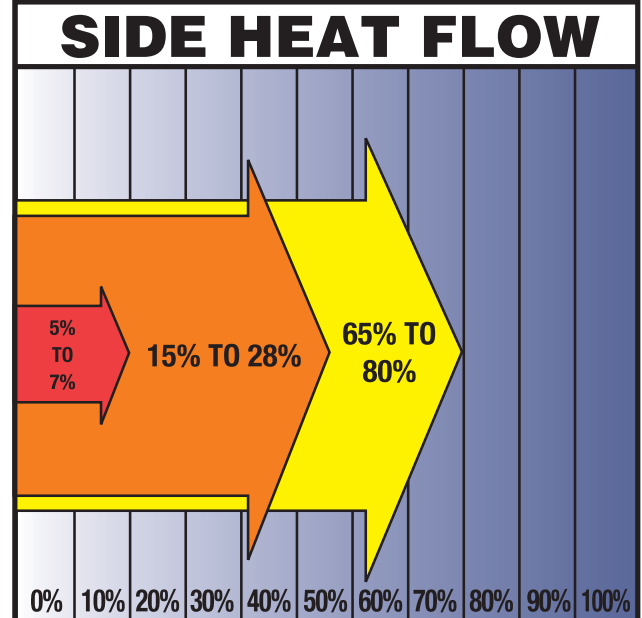
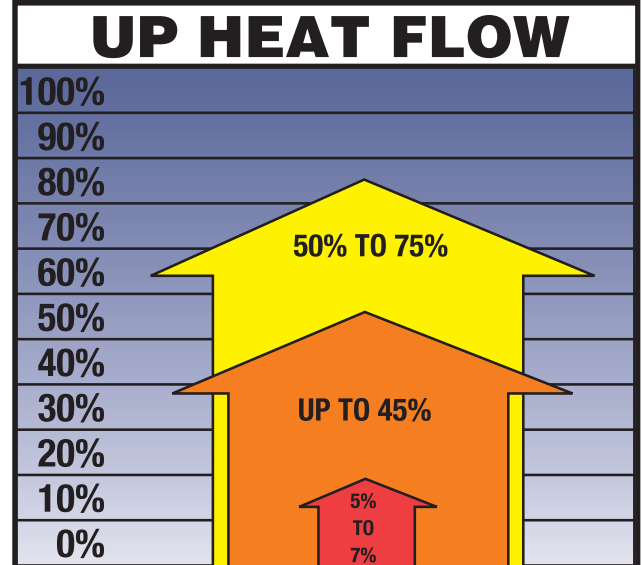
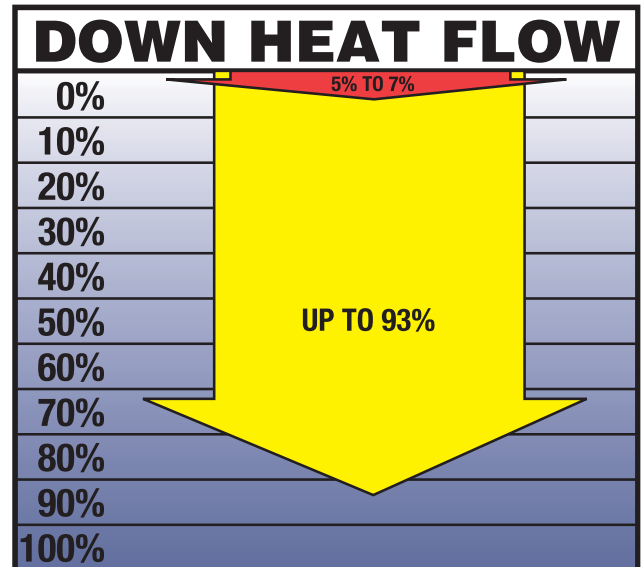

Some of our most popular buildings...



1
30'x50'x10'
 Shown with trim
 color sliding door



6
24'x30'x10'
 w/ 9'x30' open end
 shed



2
30'x50'x12'
 w/1-15'x50' closed
 end shed



7
60'x66'
Monument
 w/ living quarters
 (3'x4' windows and
 dutch doors optional)



3
30'x50'x14'
 w/1-9'x50'
 drop shed



HORSE BARN **8**
36'x36'x12'
 (shed and
 dutch doors
 are optional)



4
40'x60'x10'
 1' soffit & fascia
 overhang is optional



**RAISED CENTER
 AISLE BARN** **9**
36'x48'
Monument
 (bale door, split
 slider w/
 crossbucks and
 dutch doors are
 optional)



5
40'x60'x12'
 w/1-15'x60' closed
 end shed



HORSE BARN **10**
36'x60'x12'
 w/8'x60' open end
 shed (dutch doors
 are optional)

NOTE: You can choose doors and other options that you desire.

Some frequently asked questions:

Q. What makes National Barn better than their competitors?

A. National Barn builds every building with pride. First, we space our trusses at 5' o.c. (4' o.c. in Indiana) Many post frame builders install trusses at 8' or 10' o.c. in order to cut costs. Trusses are a key element of a building's integrity. The more trusses you have, the better the structural integrity. Second, we run our end posts all the way up to the rafters, rather than stopping at the ceiling joists. This gives our buildings a much greater structural integrity, as well as a higher wind load. Third, we NEVER use sheet metal known as "seconds." "Seconds" or "#2" sheet metal does not carry a manufacturer's warranty like #1 does. Some builders will claim that "seconds" are just as good as #1, but keep in mind they are "seconds" for a reason. Usually seconds are created when there is a problem with the way the paint adheres to the metal, which may lead to excessive fading and peeling. For whatever reason the metal manufacturer is unable to warranty the product, so it is sold to the builder at a discounted price. All our painted metal carries a limited lifetime warranty. Fourth, our posts are set 3' into the ground for a more solid footing, and to ensure that your footing is well below the frost line.

Q. Do I need to have the building pad level?

A. YES. You should have the building pad as level as possible. National Barn will level the building from the highest part of the ground. If the ground is not level there will be a gap under the

building where the ground slopes. The ground needs to be within 6" of level. This may require hiring an excavator or using a transit to determine if the ground is level. If National Barn is pouring concrete in the building, the pad must be level within 2".

Q. What happens if National Barn arrives to begin construction of my building and they determine that the building pad is more than 6" out of level?

A. National Barn strives to make every customer happy. It puts us in a difficult situation if we dispatch a crew and they are unable to begin construction, due to a pad that is more than 6" out of level. Extra costs are incurred to pay our crews for their lost time which could be transferred to the customer. We simply ask that your excavator shoot grade with a transit or line level, so that we start off on the right foot. Our sales personnel will gladly give you a run down on the steps to getting your site prepared.

Q. Can I pour a concrete slab in the building after construction is completed?

A. YES. National Barn uses a 2"x 6" MCQ treated bottom plate around the bottom of the building. This 2"x 6" can be used as a form for pouring a concrete slab. Concrete can normally be poured through the large door opening. If the concrete contractor requires additional access to pour the concrete then some wall metal could be left off and installed by the customer after the concrete is poured.





Q. Can National Barn build a Pole Barn on an existing concrete slab?

A. YES. National Barn needs to be aware of this before delivery because this affects the materials that are used for construction. Anchor bolts will need to be placed in the slab on 3' centers prior to construction (contact our office for an anchor bolt layout).

Q. Do I need to have a permit to have a Pole Barn constructed on my property?

A. MAYBE. Some counties or cities will require a building permit. The building requirements and restrictions are very different in every area. It is the customer's responsibility to check with the local building inspection office to identify any building restrictions that may be enforced. The customer is responsible for the cost of a building permit, if one is required. National Barn can talk with the building inspector to assist in the process of obtaining a permit or determining if one will be needed for construction of a Pole Barn. Occasionally, a municipality will require site specific Engineer Sealed Drawings for your particular building. If that is the case, National Barn can provide drawings for \$750. National Barn's contracting license numbers are listed on the back of this brochure.

Q. Do I need electricity at the job site?

A. YES. The customer is usually responsible for having electricity at the job site, or they must have a generator available for the builders to use during construction. If you can't provide electricity, please let us know, and together we will make other arrangements.

Q. What happens if the builders encounter rock while digging the holes?

A. The builder will try to break through the rock with a rock bar and dig the rocks out by hand. The builders are entitled to an additional \$25 per hole for the additional labor that is required when rock is encountered. If the builder can't break through the rock with a rock bar, then a jackhammer or Bobcat will be required. It is the customer's responsibility to provide a jackhammer, compressor, or Bobcat for the builder to use. These equipment charges are deferred to the customer because there is no definitive way of determining whether or not rock will be encountered. Although rock charges are a nuisance, National Barn wants you to be aware of the possibility they could occur.

Q. What is the difference between 29 gauge and 26 gauge metal?

A. 29 gauge is in the range of .014 to .017 thickness. 26 gauge is in the range of .018 to .021 thickness and is available at additional cost.

Q. If I use painted metal on my building, can I use more than one color?

A. YES. It is very common to use as many as three different colors. Colors are normally indicated for the roof, walls, and trim. National Barn offers 20 different colors to choose from and will send you a color chart for you to review. The paint has a limited lifetime warranty. Options for alternative siding are available: poplar, oak or vinyl.



Frequently asked questions, continued

Q. Do I need to send a deposit when I order a building?

A. NO. National Barn collects half of the contract price when the materials are delivered to your building site, and the balance is collected when the building is completed. The first payment is given to the delivery driver, and the second payment is given to the builder. Personal checks are acceptable up to \$4000 and must be made out to National Barn Company. If a credit card is used then you would need to call the office and tell them your card # and expiration date. A cashier's check will be acceptable for payments in excess of \$4000.

Q. When I send in a contract, how long does it take before construction begins?

A. National Barn will contact you by phone to verify that the contract was received and to estimate an approximate start date. National Barn constructs each building in the order that it was received. Weather conditions and production will affect the lead-time. A representative from National Barn will contact you prior to delivering the materials to arrange a day and time for making the delivery. They will also contact you prior to the arrival of the builders (usually 7 to 14 days after delivery) so that you can make arrangements to meet them at the building site. We will always strive to work around your schedule on deliveries and construction.

Q. Can National Barn install an overhead door in my building?

A. YES. National Barn does install overhead doors to all areas. If you decide not to purchase overhead doors with National Barn we can install metal trim around the opening. The customer can contact a local overhead door company to install a door. Most overhead doors will require clearance for overhead track. If you order a 10' tall building then the maximum door height that you can use is 8'. The customer will need to check with their overhead door company and verify the size of the opening that they will require. This information must be given to National Barn before construction begins. If you are going to pour a concrete slab inside the building it is important to remember that the thickness of the slab will affect the door clearance.

Q. Will I need to pay additional taxes for my building?

A. NO. All sales taxes are included in the price that you received when you called for your quote.

Q. Who contacts the local utility locator?

A. It is the customer's responsibility to contact the utility locator after the contract is signed.





Q. What type of horse stalls can National Barn install in my building?

A. National Barn offers factory produced stall fronts. Our stalls offer flexibility for color customization and options such as: swing-out feeders, drop down doors, etc. All stalls are powder coated or painted for maximum durability and the quality of these stall fronts is unmatched in the industry.

Q. Will my metal building have condensation?

A. Probably. The laws of physics dictate that a metal building exposed to humidity will collect moisture at times. However, if you insulate your building or concrete the floor or both, you will virtually eliminate condensation. Also, a moisture barrier of at least 4 mil plastic should be put down under any concrete or gravel floor that you install.

Q. I have always heard that skylights leak: Is that true?

A. The truth is that skylights require maintenance. Unlike the rest of your pole building, which is virtually maintenance free, skylights may need to be re-caulked every 3-5 years to prevent leakage. You should be aware that if you insulate the roof of your building you cannot have skylights.

Q. What is the difference in wall height and ceiling clearance?

A. The post frame industry uses outside wall height as the industry standard for measuring size. A 10' wall height (or eave height) does not mean that there is 10' of clearance inside your building. Typically if you have a 10' wall, your clearance inside is approximately 9'4" because of header plates and ceiling joists. If you build up your floor

with concrete then you will take away additional clearance. For that reason, National Barn builds our sliding doors 1' shorter than the specified wall height and overhead door frame outs 2' shorter than specified wall height. That way anything that fits through the doors will certainly clear the ceiling joists.

Q. Does National Barn build other sizes?

A. YES. National Barn can customize your building to fit your needs within certain boundaries. We can build wall heights of 10', 12', 14', 16', 18' and 20'. We can build any width up to 80' and any length imaginable.

Q. What is the standard roof slope of buildings constructed by National Barn?

A. National Barn constructs all standard buildings with a 4/12 slope (40' wide is 3/12) however, 5/12 and 6/12 slopes are available.

Q. Is it important for my contractor to be insured?

A. Yes. Whether you choose National Barn as your contractor or another company, it is critical that they be fully insured. National Barn's contractors and employees are fully insured specifically to protect our interests and the interests of our customers. We have complete Liability Insurance as well as Workman's Compensation and Builder's Risk Insurance.





EASTERN DIVISION

818 North Broadway • Portland, TN 37148

1-888-427-BARN (2276) • 1-615-325-2700

1-615-325-2701 fax

Email: NBCED@mindspring.com

www.nationalbarn.com

Serving Alabama, Florida, Georgia,
Indiana, Kentucky, Mississippi, North
Carolina, South Carolina, and Tennessee.

SC. LIC. #G114644

TN. LIC. #00061409

NC. LIC. #67965GA. LIC. #

RLC0002623

TN License reciprocates in the states of AL, KY,
MS and IN. SC License reciprocated in NC.